



RECORD OF TITLE
UNDER LAND TRANSFER ACT 2017
CROSS LEASE
Search Copy

DISCLAIMER

This document has been obtained on behalf of the client and is made available to customers for general information purposes only. Neither Barfoot & Thompson nor their client warrant the accuracy, completeness or currency of this document nor do they accept liability for any errors or omissions in this document. All customers should obtain and rely on their own documents and legal advice.



R. W. Muir
Registrar-General
of Land

Identifier **NA61B/163**
Land Registration District **North Auckland**
Date Issued 31 October 1985

Prior References
 NA156/153

Estate Fee Simple - 1/6 share
Area 1006 square metres more or less
Legal Description Part Lot 19 Deposited Plan 1642

Registered Owners
 The Irvine Company Limited

Estate	Leasehold	Instrument	L B475570.3
		Term	999 years commencing on the 18.9.1985

Legal Description Flat 3 Deposited Plan 108653 and Garage
 4 Deposited Plan 108653

Registered Owners
 The Irvine Company Limited

Interests

- B475570.1 Lease of Flat 1 Composite CT NA61B/161 issued - 31.10.1985 (Affects Fee Simple)
- B475570.2 Lease of Flat 2 Composite CT NA61B/162 issued - 31.10.1985 (Affects Fee Simple)
- Land Covenant in Lease B475570.2 - 31.10.1985 (Affects Fee Simple)
- B475570.3 Lease of Flat 3 and Garage 4 DP 108653 Term 999 years commencing on the 18.9.1985 Composite CT NA61B/163 issued - 31.10.1985 (Affects Fee Simple)
- B475570.4 Lease of Flat 4 Composite CT NA61B/164 issued - 31.10.1985 (Affects Fee Simple)
- B475570.5 Lease of Flat 5 Composite CT NA61B/165 issued - 31.10.1985 (Affects Fee Simple)
- B475570.6 Lease of Flat 6 Composite CT NA61B/166 issued - 31.10.1985 (Affects Fee Simple)
- 10256795.2 Mortgage to Bank of New Zealand - 25.11.2015 at 5:28 pm

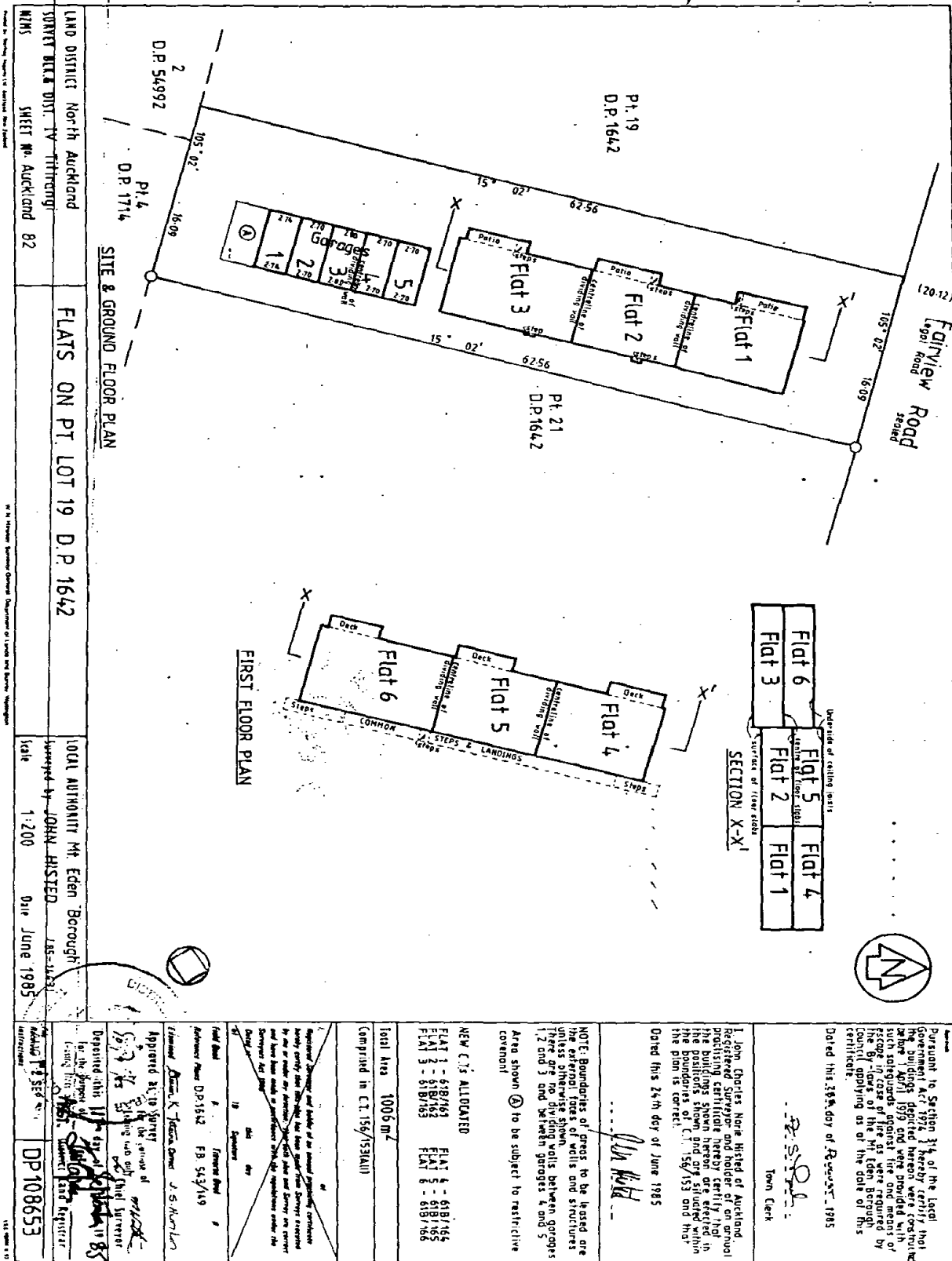

LAND DISTRICT North Auckland
TOWNSET BLOCK DIST. IV Fitzroy
MIRIS SHEET NO. AUCKLAND 82

FLATS ON PT. LOT 19 D.P. 1642
SITE & GROUND FLOOR PLAN

LOCAL AUTHORITY Mt. Eden Borough
Designed by JOHN HIRSTED
Scale 1:200 Date June 1985

DP108653

Pl. 19
D.P. 1642
Pl. 21
D.P. 1642
Pl. 4
D.P. 1714
Pl. 2
D.P. 54992

Pl. 19
D.P. 1642
Pl. 21
D.P. 1642
Pl. 4
D.P. 1714
Pl. 2
D.P. 54992

Pl. 19
D.P. 1642
Pl. 21
D.P. 1642
Pl. 4
D.P. 1714
Pl. 2
D.P. 54992

Pl. 19
D.P. 1642
Pl. 21
D.P. 1642
Pl. 4
D.P. 1714
Pl. 2
D.P. 54992

Pl. 19
D.P. 1642
Pl. 21
D.P. 1642
Pl. 4
D.P. 1714
Pl. 2
D.P. 54992

Pl. 19
D.P. 1642
Pl. 21
D.P. 1642
Pl. 4
D.P. 1714
Pl. 2
D.P. 54992

Pl. 19
D.P. 1642
Pl. 21
D.P. 1642
Pl. 4
D.P. 1714
Pl. 2
D.P. 54992

Pl. 19
D.P. 1642
Pl. 21
D.P. 1642
Pl. 4
D.P. 1714
Pl. 2
D.P. 54992

Pl. 19
D.P. 1642
Pl. 21
D.P. 1642
Pl. 4
D.P. 1714
Pl. 2
D.P. 54992

35797C-50,000/5/85MK