



**RECORD OF TITLE**  
**UNDER LAND TRANSFER ACT 2017**  
**CROSS LEASE**

**Search Copy**

**DISCLAIMER**

*This document has been obtained on behalf of the client and is made available to customers for general information purposes only. Neither Barfoot & Thompson nor their client warrant the accuracy, completeness or currency of this document nor do they accept liability for any errors or omissions in this document. All customers should obtain and rely on their own documents and legal advice.*



**Identifier** **NA59B/682**  
**Land Registration District** **North Auckland**  
**Date Issued** 17 May 1985

**Prior References**

NA55D/199                      NA57C/87                      NA57C/88

**Estate**                      Fee Simple - 1/8 share  
**Area**                      3449 square metres more or less  
**Legal Description**      Lot 1 Deposited Plan 101213

**Registered Owners**  
 Teena Maree Chapman as Executor

<b>Estate</b>	Leasehold	<b>Instrument</b>	L B414842.3
		<b>Term</b>	999 years as from and including 10.5.1985

**Legal Description** Flat 3 Deposited Plan 106386  
**Registered Owners**  
 Teena Maree Chapman as Executor

**Interests**

- B347611.1 Lease of Flat 4 Plan 103933 Composite CT NA57C/87 issued (Affects Fee Simple)
- Land Covenant in Lease B347611.1 (Affects Fee Simple)
- B347611.2 Lease of Flat 5 Plan 103933 Composite CT NA57C/88 issued (Affects Fee Simple)
- Land Covenant in Lease B347611.2 (Affects Fee Simple)
- B379649.3 Variation of Lease B347611.1 - 11.2.1985 at 11.43 am (Affects Fee Simple)
- B379649.4 Variation of Lease B347611.2 - 11.2.1985 at 11.43 am (Affects Fee Simple)
- B414842.1 Lease of Flat 1 Plan 103268 Composite CT NA56D/1222 issued - 17.5.1985 (Affects Fee Simple)
- Land Covenant in Lease B414842.1 - 17.5.1985 (Affects Fee Simple)
- B414842.2 Lease of Flat 2 DP 106386 Composite CT NA59B/681 issued - 17.5.1985 (Affects Fee Simple)
- Land Covenant in Lease B414842.2 - 17.5.1985 (Affects Fee Simple)
- Land Covenant in Lease B414842.3 - 17.5.1985 (Affects Fee Simple)
- B414842.3 Lease of Flat 3 DP 106386 Term for the space of 999 years as from and including 10.5.1985 Composite CT NA59B/682 issued - 17.5.1985 (Affects Fee Simple)
- B414842.4 Lease of Flat 6 DP 106386 Composite CT NA59B/683 issued - 17.5.1985 (Affects Fee Simple)
- Land Covenant in Lease B414842.4 - 17.5.1985 (Affects Fee Simple)
- B414842.5 Lease of Flat 7 DP 106386 Composite CT NA59B/684 issued - 17.5.1985 (Affects Fee Simple)
- Land Covenant in Lease B414842.5 - 17.5.1985 (Affects Fee Simple)
- B414842.6 Lease of Flat 8 Plan 105588 Composite CT NA59A/81 issued - 17.5.1985 (Affects Fee Simple)
- Land Covenant in Lease B414842.6 - 17.5.1985 (Affects Fee Simple)
- 11472819.1 CAVEAT BY HER MAJESTY THE QUEEN - 19.6.2019 at 11:12 am

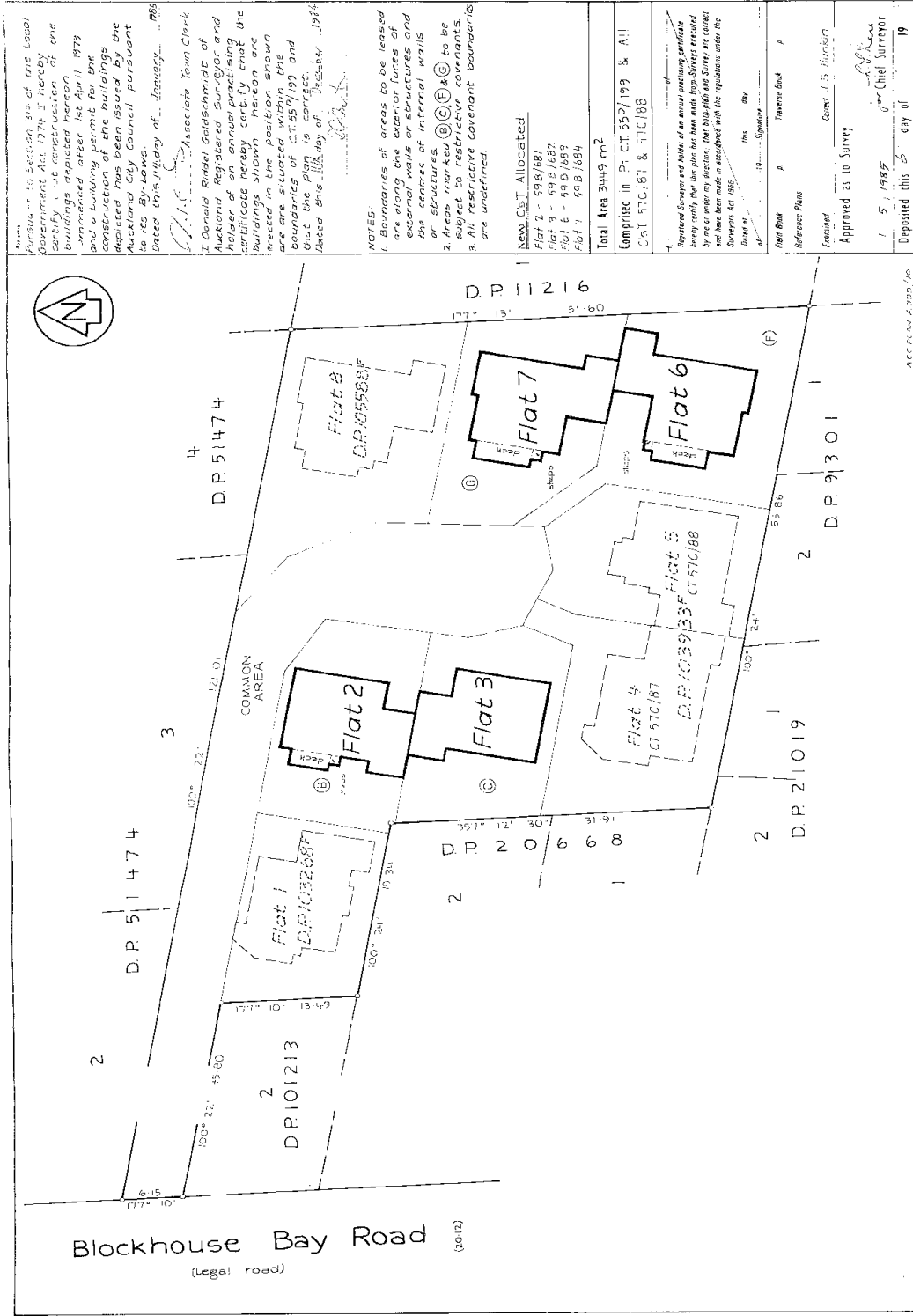

LAND DISTRICT North Auckland  
 SURVEY BLK. & DIST. III Tiritangi  
 SHEET No Auckland III

LOCAL AUTHORITY Auckland City  
 Surveyed by Jackson Clapperton (Geodeticmatic Points)  
 Scale 1:250  
 Date Dec, 1984

Plan of Flats on Lot I D.P. 101213

NOTED:  
 1. Boundaries of areas to be leased are along the external walls of the structures and the centres of internal walls or structures.  
 2. Areas marked (C) (E) (F) to be subject to restrictive covenants.  
 3. All restrictive covenant boundaries are undefined.

NEW C.B.T. Allocated:  
 Flat 2 - 598/887  
 Flat 3 - 693/682  
 Flat 4 - 593/683  
 Flat 5 - 598/684

Total Area 3449 sq. ft.  
 Comprised in P. CT. 559/199 & All C.B.T. 570187 & 570188

Registered Surveyor and holder of an annual practicing certificate hereby certify that this plan has been made with due care and accuracy and that the same have been made in accordance with the regulations under the Survey Act 1952.

File No. 1985  
 District Land Registrar  
 DP106386

APPROVED AS TO SURVEY  
 15/1985  
 Chief Surveyor

APPROVED AS TO SURVEY  
 15/1985  
 Chief Surveyor

APPROVED AS TO SURVEY  
 15/1985  
 Chief Surveyor



