



**RECORD OF TITLE  
UNDER LAND TRANSFER ACT 2017  
GROSS LEASE**

**Search Copy**

*This document has been obtained on behalf of the client and is made available to customers for general information purposes only. Neither Barfoot & Thompson nor their client warrant the accuracy, completeness or currency of this document nor do they accept liability for any errors or omissions in this document. All customers should obtain and rely on their own documents and legal advice.*



R. W. Muir  
Registrar-General  
of Land

**Identifier** NA127D/712  
**Land Registration District** North Auckland  
**Date Issued** 03 February 2000

**Prior References**  
 NA1820/1

**Estate** Fee Simple - 1/2 share  
**Area** 771 square metres more or less  
**Legal Description** Part Lot 1 Deposited Plan 21868

**Registered Owners**  
 Li Chuan Chen

<b>Estate</b>	Leasehold	<b>Instrument</b>	L D472582.2
		<b>Term</b>	999 years commencing on 9.12.1997

**Legal Description** Flat 2 Deposited Plan 199227

**Registered Owners**  
 Li Chuan Chen

**Interests**

- Fencing Agreement in Transfer 310645 (Affects Fee Simple)
- D253308.4 Lease of Flat 1 DP 185779 CT NA116A/915 issued (Affects Fee Simple)
- D472582.2 Lease of Flat 2 DP 199227 Term 999 years commencing on 9.12.1997 Composite CT NA127D/712 issued - produced 25.1.2000 at 3.55 pm and entered 3.2.2000 at 9.00 am (Affects Fee Simple)
- 7356265.3 Mortgage to Westpac New Zealand Limited - 6.6.2007 at 2:42 pm

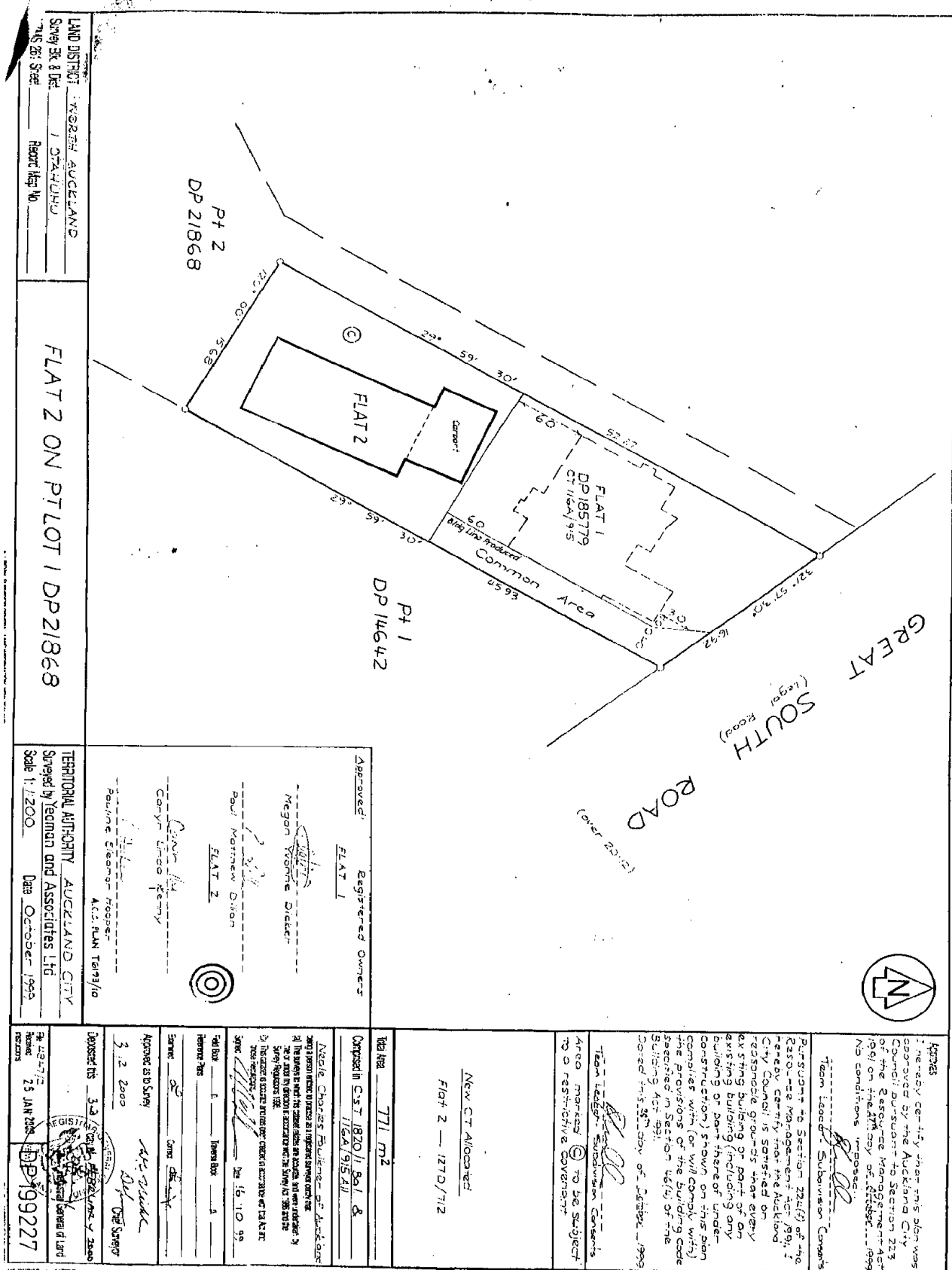

LAND DISTRICT: NORTH AUCKLAND  
 Survey Bk & Dist: 1 STAVURHU  
 745 265 Street Report Map No

FLAT 2 ON PLOT 1 DP21868

Approved: Registered Owners  
 Megan Young Dickler  
 Paul Norman Dixon  
 Garyn Lingo Kenny  
 Pauline Clempner Hooper  
 A.C.S. PLAN T0193/10

TERMINAL AUTHORITY: AUCKLAND CITY  
 Surveyed by Tegman and Associates Ltd  
 Scale 1:1200 Date October 1999

Total Area: 771 m<sup>2</sup>  
 Compasell in C/S T 1820/1, 961 & 1164/915/211  
 Note: Charles Builders of Auckland...  
 The survey is made in accordance with the Survey Act 1980 and the Survey Regulations 1982.  
 The boundaries are shown in accordance with the Survey Act 1980.  
 The survey was carried out on the 15.10.99.  
 Surveyed by: [Signature]  
 Checked by: [Signature]  
 Approved as to Survey: [Signature]  
 Date: 3.12.2000  
 Deposited this 3rd day of December 2000  
 Registrar of Land

Area marked ② to be subject to a restrictive covenant.  
 Pursuant to Section 224(1) of the Resource Management Act 1991, I hereby certify that the Auckland City Council is satisfied on reasonable grounds that every existing building or part of an existing building (including any building or part thereof under construction) shown on this plan complies with (or will comply with) the provisions of the building code specified in Section 46(1) of the Building Act 1991.  
 Dated this 27th day of October 1999.  
 Team Leader, Subdivision Contents

Agrees  
 I hereby certify that this plan was approved by the Auckland City Council pursuant to Section 223 of the Resource Management Act 1991 on the 27th day of October 1999. No conditions imposed.  
 [Signature]  
 Team Leader of Subdivision Contents