



**RECORD OF TITLE
UNDER LAND TRANSFER ACT 2017
UNIT TITLE**

Search Copy

DISCLAIMER

This document has been obtained on behalf of the client and is made available to customers for general information purposes only. Neither Barfoot & Thompson nor their client warrant the accuracy, completeness or currency of this document nor do they accept liability for any errors or omissions in this document. All customers should obtain and rely on their own documents and legal advice.



R. W. Muir
Registrar-General
of Land

Identifier NA136C/934
Land Registration District North Auckland
Date Issued 11 September 2001

Prior References NA136B/864 **Supplementary Record Sheet**
NA136C/942

Estate Stratum in Freehold
Legal Description Unit 51 and Accessory Unit 51 Deposited
 Plan 208399

Registered Owners
 Bhupinder Singh Dalal and Ritu Chowdhary

The above estates are subject to the reservations, restrictions, encumbrances, liens and interests noted below and on the relevant unit plan and supplementary record sheet
 D639246.7 Consent Notice pursuant to Section 221(1) Resource Management Act 1991 - 11.9.2001 at 3.04 pm
 11095734.2 Mortgage to ASB Bank Limited - 10.5.2018 at 5:54 pm

Identifier

NA136C/934



**SUPPLEMENTARY RECORD SHEET
UNDER UNIT TITLES ACT 1972**

Search Copy

Identifier

NA136C/942

Land Registration District

North Auckland

Date Issued

11 September 2001

Plan Number

DP 208399

Subdivision of

Lot 1 Deposited Plan 207999

Prior References

NA136B/864

Unit Titles Issued

NA136C/884	NA136C/885	NA136C/886	NA136C/887
NA136C/888	NA136C/889	NA136C/890	NA136C/891
NA136C/892	NA136C/893	NA136C/894	NA136C/895
NA136C/896	NA136C/897	NA136C/898	NA136C/899
NA136C/900	NA136C/901	NA136C/902	NA136C/903
NA136C/904	NA136C/905	NA136C/906	NA136C/907
NA136C/908	NA136C/909	NA136C/910	NA136C/911
NA136C/912	NA136C/913	NA136C/914	NA136C/915
NA136C/916	NA136C/917	NA136C/918	NA136C/919
NA136C/920	NA136C/921	NA136C/922	NA136C/923
NA136C/924	NA136C/925	NA136C/926	NA136C/927
NA136C/928	NA136C/929	NA136C/930	NA136C/931
NA136C/932	NA136C/933	NA136C/934	NA136C/935
NA136C/936	NA136C/937	NA136C/938	NA136C/939
NA136C/940	NA136C/941		

Interests

OWNERSHIP OF COMMON PROPERTY

Pursuant to Section 47 Unit Titles Act 2010 -

(a) the body corporate owns the common property and

(b) the owners of all the units are beneficially entitled to the common property as tenants in common in shares proportional to the ownership interest (or proposed ownership interest) in respect of their respective units.

The above memorial has been added to Supplementary Record Sheets issued under the Unit Titles Act 1972 to give effect to Section 47 of the Unit Titles Act 2010.

Appurtenant hereto is a right of way created by Transfer D488344.1 - produced 16.3.2000 at 3.31 pm and entered 31.3.2000 at 9.00 am

Subject to a right of way over part marked A on DP 207999 created by Transfer D639246.3 - 11.9.2001 at 3.04 pm
639246.7 Consent Notice pursuant to Section 221(1) Resource Management Act 1991 - 11.9.2001 at 3.04 pm

D639246.10 Change of rules of the Body Corporate - 11.9.2001 at 3.04 pm

9213177.1 Notice of change of body corporate operational rules pursuant to Section 106 Unit Titles Act 2010 - 18.10.2012 at 7:00 am

10131425.1 Notice of application to the High Court pursuant to Section 74(5) Unit Titles Act 2010 to Settle Scheme - 22.7.2015 at 12:29 pm

Micro Record Bureau Ltd. MAIN CONVERSION
 20 SEP 2001
 1 2 3 4 5 6 7 8 9 10 11 12 13 14 15 16 17 18 19 20 21 22 23 24 25 26 27 28 29 30 31 32 33 34 35 36 37 38 39 40 41 42 43 44 45 46 47 48 49 50 51 52 53 54 55 56 57 58 59 60 61 62 63 64 65 66 67 68 69 70 71 72 73 74 75 76 77 78 79 80 81 82 83 84 85 86 87 88 89 90 91 92 93 94 95 96 97 98 99 100

Approvals
 PRINCIPAL UNIT BOUNDARIES ARE TO THE EXTERNAL FACE OF EXTERNAL WALLS AND TO THE CENTRELINE OF WALLS WHERE APPLICABLE. ACCESSORY UNITS OR DEPENDANTS HEREON OF THE CENTRELINE OF WALLS BETWEEN PRINCIPAL UNITS OR AS DIMENSIONED ON PLAN.
 ACCESSORY UNITS 66B, 63A, 69, 70, 72 & 73 ARE TO THE EXTENT OF CARPORT ROOF.

SHEET 2 OF 3
 CLASS OF SURVEY: 1
 Total Area 9716.2m²
 Comprised in CT136B/864
 I. GLEN ALEXANDER METCALE OF AUCKLAND
 Surveyor
 Date 16 September 2001.
 Approved by the Registrar-General of Land
 Date 11 SEP 2001
 DP 208399

SCHEDULE		SCHEDULE		SCHEDULE	
Description	Area (m ²)	Description	Area (m ²)	Description	Area (m ²)
Unit 1	10.00	Unit 1	10.00	Unit 1	10.00
Unit 2	10.00	Unit 2	10.00	Unit 2	10.00
Unit 3	10.00	Unit 3	10.00	Unit 3	10.00
Unit 4	10.00	Unit 4	10.00	Unit 4	10.00
Unit 5	10.00	Unit 5	10.00	Unit 5	10.00
Unit 6	10.00	Unit 6	10.00	Unit 6	10.00
Unit 7	10.00	Unit 7	10.00	Unit 7	10.00
Unit 8	10.00	Unit 8	10.00	Unit 8	10.00
Unit 9	10.00	Unit 9	10.00	Unit 9	10.00
Unit 10	10.00	Unit 10	10.00	Unit 10	10.00
Unit 11	10.00	Unit 11	10.00	Unit 11	10.00
Unit 12	10.00	Unit 12	10.00	Unit 12	10.00
Unit 13	10.00	Unit 13	10.00	Unit 13	10.00
Unit 14	10.00	Unit 14	10.00	Unit 14	10.00
Unit 15	10.00	Unit 15	10.00	Unit 15	10.00
Unit 16	10.00	Unit 16	10.00	Unit 16	10.00
Unit 17	10.00	Unit 17	10.00	Unit 17	10.00
Unit 18	10.00	Unit 18	10.00	Unit 18	10.00
Unit 19	10.00	Unit 19	10.00	Unit 19	10.00
Unit 20	10.00	Unit 20	10.00	Unit 20	10.00
Unit 21	10.00	Unit 21	10.00	Unit 21	10.00
Unit 22	10.00	Unit 22	10.00	Unit 22	10.00
Unit 23	10.00	Unit 23	10.00	Unit 23	10.00
Unit 24	10.00	Unit 24	10.00	Unit 24	10.00
Unit 25	10.00	Unit 25	10.00	Unit 25	10.00
Unit 26	10.00	Unit 26	10.00	Unit 26	10.00
Unit 27	10.00	Unit 27	10.00	Unit 27	10.00
Unit 28	10.00	Unit 28	10.00	Unit 28	10.00
Unit 29	10.00	Unit 29	10.00	Unit 29	10.00
Unit 30	10.00	Unit 30	10.00	Unit 30	10.00
Unit 31	10.00	Unit 31	10.00	Unit 31	10.00
Unit 32	10.00	Unit 32	10.00	Unit 32	10.00
Unit 33	10.00	Unit 33	10.00	Unit 33	10.00
Unit 34	10.00	Unit 34	10.00	Unit 34	10.00
Unit 35	10.00	Unit 35	10.00	Unit 35	10.00
Unit 36	10.00	Unit 36	10.00	Unit 36	10.00
Unit 37	10.00	Unit 37	10.00	Unit 37	10.00
Unit 38	10.00	Unit 38	10.00	Unit 38	10.00
Unit 39	10.00	Unit 39	10.00	Unit 39	10.00
Unit 40	10.00	Unit 40	10.00	Unit 40	10.00
Unit 41	10.00	Unit 41	10.00	Unit 41	10.00
Unit 42	10.00	Unit 42	10.00	Unit 42	10.00
Unit 43	10.00	Unit 43	10.00	Unit 43	10.00
Unit 44	10.00	Unit 44	10.00	Unit 44	10.00
Unit 45	10.00	Unit 45	10.00	Unit 45	10.00
Unit 46	10.00	Unit 46	10.00	Unit 46	10.00
Unit 47	10.00	Unit 47	10.00	Unit 47	10.00
Unit 48	10.00	Unit 48	10.00	Unit 48	10.00
Unit 49	10.00	Unit 49	10.00	Unit 49	10.00
Unit 50	10.00	Unit 50	10.00	Unit 50	10.00
Unit 51	10.00	Unit 51	10.00	Unit 51	10.00
Unit 52	10.00	Unit 52	10.00	Unit 52	10.00
Unit 53	10.00	Unit 53	10.00	Unit 53	10.00
Unit 54	10.00	Unit 54	10.00	Unit 54	10.00
Unit 55	10.00	Unit 55	10.00	Unit 55	10.00
Unit 56	10.00	Unit 56	10.00	Unit 56	10.00
Unit 57	10.00	Unit 57	10.00	Unit 57	10.00
Unit 58	10.00	Unit 58	10.00	Unit 58	10.00
Unit 59	10.00	Unit 59	10.00	Unit 59	10.00
Unit 60	10.00	Unit 60	10.00	Unit 60	10.00
Unit 61	10.00	Unit 61	10.00	Unit 61	10.00
Unit 62	10.00	Unit 62	10.00	Unit 62	10.00
Unit 63	10.00	Unit 63	10.00	Unit 63	10.00
Unit 64	10.00	Unit 64	10.00	Unit 64	10.00
Unit 65	10.00	Unit 65	10.00	Unit 65	10.00
Unit 66	10.00	Unit 66	10.00	Unit 66	10.00
Unit 67	10.00	Unit 67	10.00	Unit 67	10.00
Unit 68	10.00	Unit 68	10.00	Unit 68	10.00
Unit 69	10.00	Unit 69	10.00	Unit 69	10.00
Unit 70	10.00	Unit 70	10.00	Unit 70	10.00
Unit 71	10.00	Unit 71	10.00	Unit 71	10.00
Unit 72	10.00	Unit 72	10.00	Unit 72	10.00
Unit 73	10.00	Unit 73	10.00	Unit 73	10.00
Unit 74	10.00	Unit 74	10.00	Unit 74	10.00
Unit 75	10.00	Unit 75	10.00	Unit 75	10.00
Unit 76	10.00	Unit 76	10.00	Unit 76	10.00
Unit 77	10.00	Unit 77	10.00	Unit 77	10.00
Unit 78	10.00	Unit 78	10.00	Unit 78	10.00
Unit 79	10.00	Unit 79	10.00	Unit 79	10.00
Unit 80	10.00	Unit 80	10.00	Unit 80	10.00
Unit 81	10.00	Unit 81	10.00	Unit 81	10.00
Unit 82	10.00	Unit 82	10.00	Unit 82	10.00
Unit 83	10.00	Unit 83	10.00	Unit 83	10.00
Unit 84	10.00	Unit 84	10.00	Unit 84	10.00
Unit 85	10.00	Unit 85	10.00	Unit 85	10.00
Unit 86	10.00	Unit 86	10.00	Unit 86	10.00
Unit 87	10.00	Unit 87	10.00	Unit 87	10.00
Unit 88	10.00	Unit 88	10.00	Unit 88	10.00
Unit 89	10.00	Unit 89	10.00	Unit 89	10.00
Unit 90	10.00	Unit 90	10.00	Unit 90	10.00
Unit 91	10.00	Unit 91	10.00	Unit 91	10.00
Unit 92	10.00	Unit 92	10.00	Unit 92	10.00
Unit 93	10.00	Unit 93	10.00	Unit 93	10.00
Unit 94	10.00	Unit 94	10.00	Unit 94	10.00
Unit 95	10.00	Unit 95	10.00	Unit 95	10.00
Unit 96	10.00	Unit 96	10.00	Unit 96	10.00
Unit 97	10.00	Unit 97	10.00	Unit 97	10.00
Unit 98	10.00	Unit 98	10.00	Unit 98	10.00
Unit 99	10.00	Unit 99	10.00	Unit 99	10.00
Unit 100	10.00	Unit 100	10.00	Unit 100	10.00

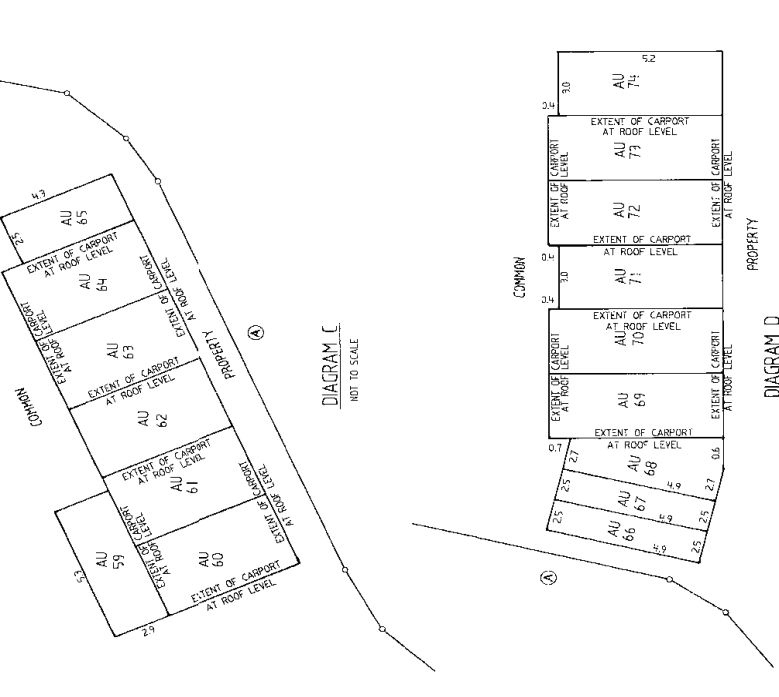

LAND DISTRICT NORTH AUCKLAND
 SURVEY BLK. & DST. 1 OTAHUHU
 NZMS 261 SH1 RECORD MAP No.

COMPLETE UNIT PLAN
 ON LOT 1 DP207999

TERRITORIAL AUTHORITY AUCKLAND CITY
 Surveyed by Barry Satchell Consultants Ltd
 Scale NOT TO SCALE Date JULY 2001

Approvals

UPPER LIMIT RL: SEE SHEET 2

SCHEDULE	
DESCRIPTION	INTERMEDIATE
UNIT 9	92.00
UNIT 10	92.70
UNIT 15	93.00
UNIT 16	93.00

COMMON PROPERTY

TYPICAL CROSS SECTION OF UNITS
9, 10, 15 & 16

SECTION A-A

INTERMEDIATE LIMIT RL: SEE SCHEDULE

LOWER LIMIT RL: SEE SHEET 2

UPPER LIMIT RL: SEE SHEET 2

SCHEDULE	
DESCRIPTION	INTERMEDIATE
UNIT 24	93.15
UNIT 31	92.95
UNIT 32	92.90

COMMON PROPERTY

TYPICAL CROSS SECTION OF UNITS
24, 31 & 32

SECTION C-C

INTERMEDIATE LIMIT RL: SEE SCHEDULE

LOWER LIMIT RL: SEE SHEET 2

UPPER LIMIT RL: SEE SHEET 2

SCHEDULE	
DESCRIPTION	INTERMEDIATE
UNIT 25	93.25
UNIT 26	93.07
UNIT 27	92.90
UNIT 29	92.70
UNIT 30	92.70
UNIT 34	92.90

COMMON PROPERTY

TYPICAL CROSS SECTION OF UNITS
25, 26, 27, 29, 30, 34 & 34A

SECTION D-D

INTERMEDIATE LIMIT RL: SEE SCHEDULE

LOWER LIMIT RL: SEE SHEET 2

UPPER LIMIT RL: SEE SHEET 2

SCHEDULE	
DESCRIPTION	INTERMEDIATE
UNIT 2	92.70
UNIT 3	92.50
UNIT 4	92.50
UNIT 5	92.50
UNIT 6	92.50
UNIT 7	92.50
UNIT 8	92.50
UNIT 11	93.00
UNIT 14	94.00
UNIT 17	94.00
UNIT 20	94.00
UNIT 21	94.00
UNIT 22	93.80

COMMON PROPERTY

TYPICAL CROSS SECTION OF UNITS
2, 3, 11, 14, 17 & 20-22

SECTION B-B

INTERMEDIATE LIMIT RL: SEE SCHEDULE

LOWER LIMIT RL: SEE SHEET 2

COMPLETE UNIT PLAN
ON LOT 1 DP 207999

LAND DISTRICT NORTH AUCKLAND
SURVEY BLK & DIST. I OTAHuhu
NZMS 261 SHI RECORD MAP No.

TERRITORIAL AUTHORITY AUCKLAND CITY
Surveyed by Barry Satchell Consultants Ltd
Scale NOT TO SCALE Date JULY 2001

CLASS OF SHEET: I
SHEET 3 OF 3
Total Area 9762m²
Composed of CT 136B/864

IS AUCKLAND
If a person wishes to purchase a Registered Conveyance, early this
to the Survey Act 1980 and the Survey Regulations 1980
with the Survey Registrar-General of Land
with the Survey Registrar-General of Land

Surveyed
Date 6 September 2001

File No. 2
Reference Plan
Consent
Approved as to Survey
18/9/2001
11 day of 9 2001
10-Register-General of Land
DP 208399

