

BARFOOT & THOMPSON DISCLAIMER
 This document has been obtained on behalf of the client and is made available to customers for general information purposes only. Neither Barfoot & Thompson nor their client warrant the accuracy, completeness or currency of this document nor do they accept liability for any errors or omissions in this document. All customers should obtain and rely on their own documents and legal advice.

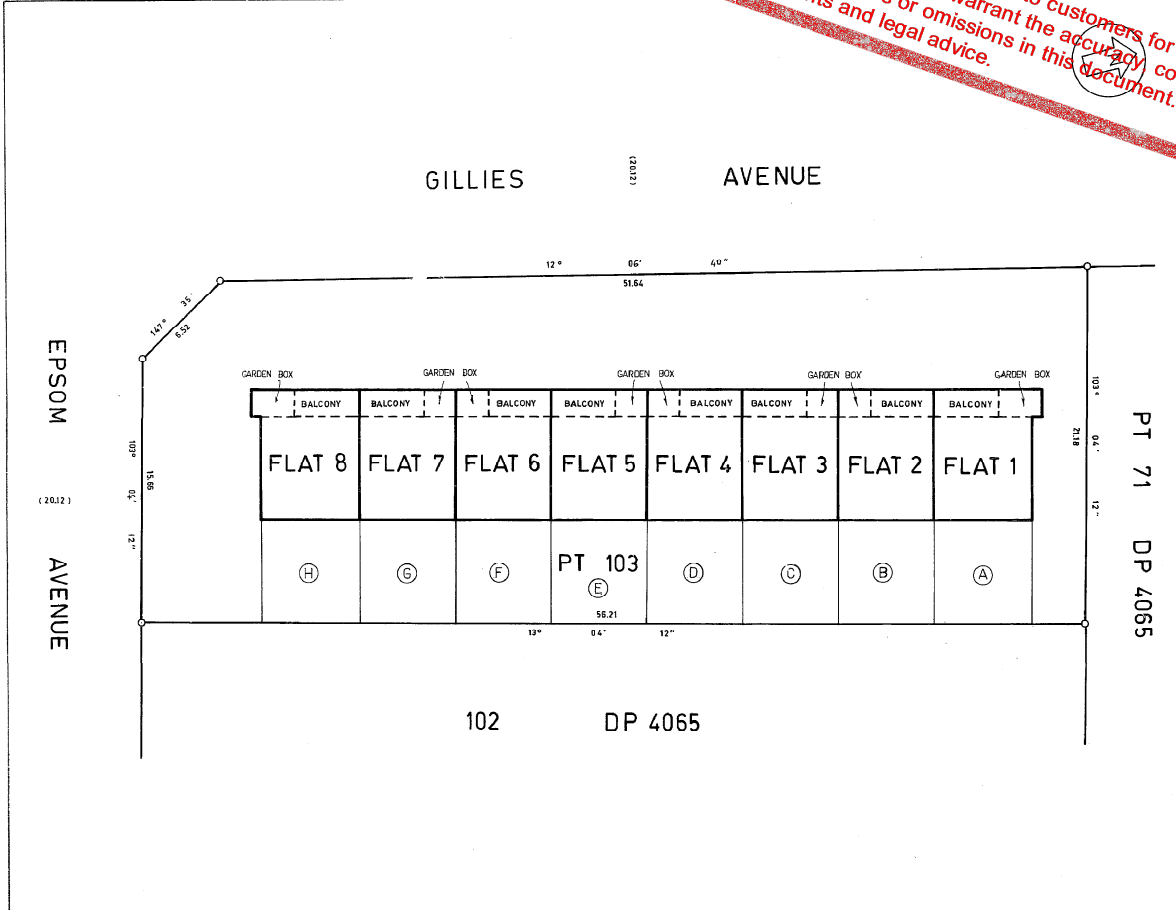

APPROVED
 REGISTERED PROPRIETOR

NOTE: FLATS 1-8 ALL HAVE FULL BASEMENTS WITH GARAGE
 BOUNDARIES OF AREAS TO BE LEASED ARE THE CENTRE OF WALLS UNLESS OTHERWISE STATED.

AREA LABELLED (A) WITH FLAT 1 SUBJECT TO THE RIGHT OF USER.
 AREA LABELLED (B) WITH FLAT 2 SUBJECT TO THE RIGHT OF USER.
 AREA LABELLED (C) WITH FLAT 3 SUBJECT TO THE RIGHT OF USER.
 AREA LABELLED (D) WITH FLAT 4 SUBJECT TO THE RIGHT OF USER.
 AREA LABELLED (E) WITH FLAT 5 SUBJECT TO THE RIGHT OF USER.
 AREA LABELLED (F) WITH FLAT 6 SUBJECT TO THE RIGHT OF USER.
 AREA LABELLED (G) WITH FLAT 7 SUBJECT TO THE RIGHT OF USER.
 AREA LABELLED (H) WITH FLAT 8 SUBJECT TO THE RIGHT OF USER.

New Cls.T. Allocated.

Flat 1	28 B	688
Flat 2	28 B	689
Flat 3	28 B	690
Flat 4	28 B	691
Flat 5	28 B	692
Flat 6	28 B	693
Flat 7	28 B	694
Flat 8	28 B	695

Total Area
 Comprised in P.T.C.T. 453/53 (BALANCE)

I, PAUL RICHARD SPENCE of HOWICK, Registered Surveyor and holder of an annual practicing certificate hereby certify that this plan has been made from Surveys executed by me or under my direction; that both plan and Survey are correct and have been made in accordance with the regulations under the Surveyors Act 1968.
 Dated at HOWICK this 15th day of MAY 1973. Signature *[Signature]*

Reference Plans
 Examined M.J. Moir Correct
 Approved as to Survey
 30 / 1 / 74
 District Land Registrar

LAND DISTRICT NORTH AUCKLAND
 SURVEY BLK. & DIST. 1 OTAHUHU
 NZMS SHEET No.

FLATS ON PT LOT 103 DP 4065

LOCAL AUTHORITY AUCKLAND CITY
 Surveyed by D.N. BOAK & PARTNERS
 Scale 1:150 Date MAY 1973

DP 71966

