



**RECORD OF TITLE
UNDER LAND TRANSFER ACT 2017
UNIT TITLE**

Search Copy

DISCLAIMER

This document has been obtained on behalf of the client and is made available to customers for general information purposes only. Neither Barfoot & Thompson nor their client warrant the accuracy, completeness or currency of this document nor do they accept liability for any errors or omissions in this document. All customers should obtain and rely on their own documents and legal advice.



R. W. Muir
Registrar-General
of Land

Identifier **799706**
Land Registration District **North Auckland**
Date Issued 27 October 2017

Prior References
NA103A/638

Supplementary Record Sheet
NA103A/642

Estate Stratum in Freehold
Legal Description Unit C and Accessory Unit 5, 12-13, 23
and 1/3 share of Accessory Unit 7
Deposited Plan 169171

Registered Owners
Andrew Graeme Stanton and Sarah Davies

The above estates are subject to the reservations, restrictions, encumbrances, liens and interests noted below and on the relevant unit plan and supplementary record sheet
 11464764.3 Mortgage to Bank of New Zealand - 19.6.2019 at 2:52 pm

Identifier

799706



**SUPPLEMENTARY RECORD SHEET
UNDER UNIT TITLES ACT 1972**

Search Copy

Identifier

NA103A/642

Land Registration District

North Auckland

Date Issued

18 August 1995

Plan Number

DP 169171

Subdivision of

Lot 1 Deposited Plan 150025

Unit Titles Issued

799704

799705

799706

799707

799708

799709

Interests

OWNERSHIP OF COMMON PROPERTY

Pursuant to Section 47 Unit Titles Act 2010 -

(a) the body corporate owns the common property and

(b) the owners of all the units are beneficially entitled to the common property as tenants in common in shares proportional to the ownership interest (or proposed ownership interest) in respect of their respective units.

The above memorial has been added to Supplementary Record Sheets issued under the Unit Titles Act 1972 to give effect to Section 47 of the Unit Titles Act 2010.

Subject to Part IV A Conservation Act 1987

Subject to Section 11 Crown Minerals Act 1991

C879741.4 Change of rules of the Body Corporate - 18.8.1995 at 3.43 pm

9262535.1 Notice of change of body corporate operational rules pursuant to Section 106 Unit Titles Act 2010 - 7.12.2012 at 7:00 am

11431849.2 Notice of change of body corporate operational rules pursuant to Section 106 Unit Titles Act 2010 - 8.5.2019 at 7:00 am

12123872.1 Change of address of the Body Corporate - 17.5.2021 at 5:15 pm

Approved as to Section 223 of the Resource Management Act 1991 on the 9th day of July 1995

Registered Owners



The Owners of the AUCKLAND CITY Council in accordance with the provisions of the Resource Management Act 1991 (1992:118) hereby certify that the AUCKLAND CITY Council has approved this plan for the purposes of the Resource Management Act 1991.

City Secretary
 A.C.C. PLAN 6-430-7/T
 Submitted to the Registrar
 24 July 1995

These Section Subdivision Consents are given pursuant to Section 223(1)(b) of the Resource Management Act 1991.

Principal Administrative Officer of the Auckland City Council hereby certifies that every building shown on this plan has been carried out to the extent necessary to enable all the boundaries of every unit and the common property shown on the plan to be physically measured.

DATED THIS 24th DAY OF JULY 1995.

Manager Consent Services

ADDRESS OF BODY CORPORATE
 21-22 RAILWAY STREET
 NEWMARKET

Total Area 1303m²
 Comprised in C.T. 538(1000A)

I, the Registrar, do hereby certify that this plan has been made from surveys conducted by me or under my direction, that the plan and surveys are correct and in accordance with the provisions of the Resource Management Act 1991.

Dated at Auckland this 24th day of July 1995.

Registrar
 M. G. GIBSON

Approved as to Survey
 9th July 1995
 M. G. GIBSON

Deposited this 24th day of July 1995

 Registrar

Filed Book 538(1000A) Page 1
 Reference Plans 538(1000A) 538(1000B) 538(1000C) 538(1000D) 538(1000E) 538(1000F) 538(1000G) 538(1000H) 538(1000I) 538(1000J) 538(1000K) 538(1000L) 538(1000M) 538(1000N) 538(1000O) 538(1000P) 538(1000Q) 538(1000R) 538(1000S) 538(1000T) 538(1000U) 538(1000V) 538(1000W) 538(1000X) 538(1000Y) 538(1000Z)

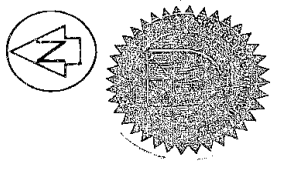
Approved L.M. 9810
 24 JUL 1995
 UP 169171

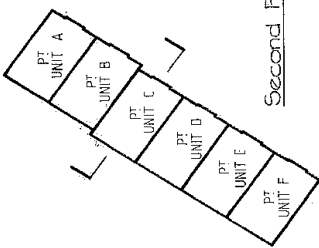

Second Floor Plan



- Boundaries for Units A-F are taken to external face of external walls and centreline of adjoining unit walls.
- Boundaries for Units A-F are taken to external face of concrete walls and centreline of adjoining unit walls.
- Boundaries for AU1-AU7 are taken to external face of concrete walls and centreline of chain link fence and gates.
- Boundaries for AU8-AU10, AU12, AU14 and AU16 are centreline of adjoining access unit walls and external face of retaining wall.
- Boundaries for AU9, AU11, AU13, AU15, AU17 and AU19 are taken to edge of concrete driveway and centreline of unit walls extended.

NEW C. ALLOCATED	DESCRIPTION	APPROX. TIDAL AREA	UNIT RENTALS	HEIGHT ABOVE M.S.L.	LIMITS
103A	UNIT A	172	172	45.50	62.50
103A	UNIT B	172	172	45.50	62.50
103A	UNIT C	172	172	45.50	62.50
103A	UNIT D	172	172	45.50	62.50
103A	UNIT E	172	172	45.50	62.50
103A	UNIT F	172	172	45.50	62.50
103A	AU 1	36	36	50.00	50.00
103A	AU 2	36	36	50.00	50.00
103A	AU 3	36	36	50.00	50.00
103A	AU 4	36	36	50.00	50.00
103A	AU 5	36	36	50.00	50.00
103A	AU 6	36	36	50.00	50.00
103A	AU 7	36	36	50.00	50.00
103A	AU 8	11	11	45.50	62.50
103A	AU 9	11	11	45.50	62.50
103A	AU 10	11	11	45.50	62.50
103A	AU 11	11	11	45.50	62.50
103A	AU 12	11	11	45.50	62.50
103A	AU 13	11	11	45.50	62.50
103A	AU 14	11	11	45.50	62.50
103A	AU 15	11	11	45.50	62.50
103A	AU 16	11	11	45.50	62.50
103A	AU 17	11	11	45.50	62.50
103A	AU 18	11	11	45.50	62.50
103A	AU 19	11	11	45.50	62.50
103A	AU 20	11	11	45.50	62.50
103A	AU 21	11	11	45.50	62.50
103A	AU 22	11	11	45.50	62.50
103A	AU 23	11	11	45.50	62.50
103A	AU 24	11	11	45.50	62.50
103A	AU 25	11	11	45.50	62.50
TOTAL UNIT RENTALS				10,600	

I, Brian Stubbins, of Auckland, Registered Valuer, hereby certify that I have measured the Unit Entitlements shown in accordance with the Unit Entitlement Act 1992.

Dated this 9th day of July 1995
 B. STUBBINS
 Registered Valuer

TERRITORIAL AUTHORITY AUCKLAND CITY
 Surveyed by HARRISON GIBSON CONSULTANTS LTD
 Scale 1:300 Date APRIL 1995

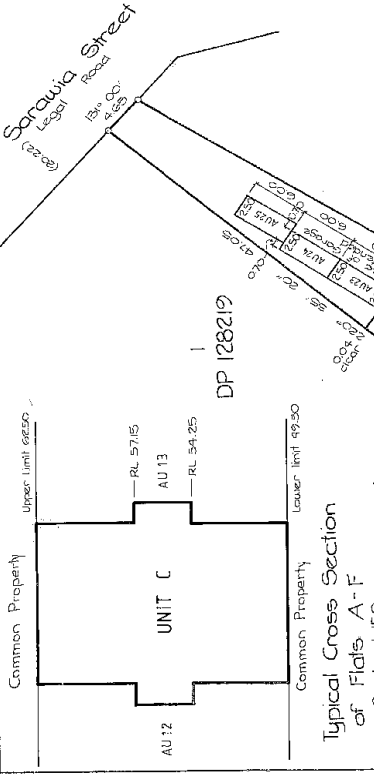

First Floor Plan

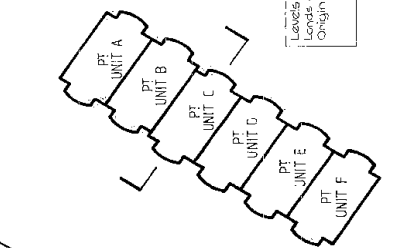

I, Brian Stubbins, of Auckland, Registered Valuer, hereby certify that I have measured the Unit Entitlements shown in accordance with the Unit Entitlement Act 1992.

Dated this 9th day of July 1995
 B. STUBBINS
 Registered Valuer

TERRITORIAL AUTHORITY AUCKLAND CITY
 Surveyed by HARRISON GIBSON CONSULTANTS LTD
 Scale 1:300 Date APRIL 1995

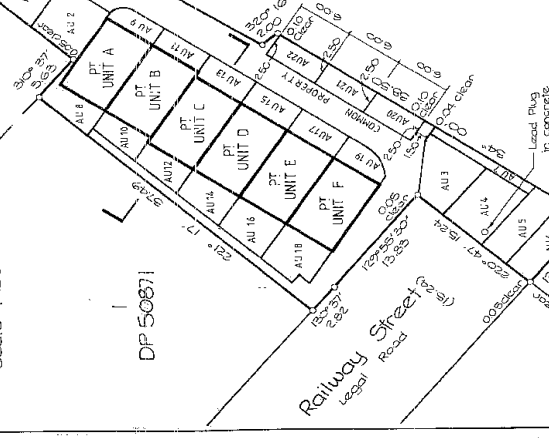
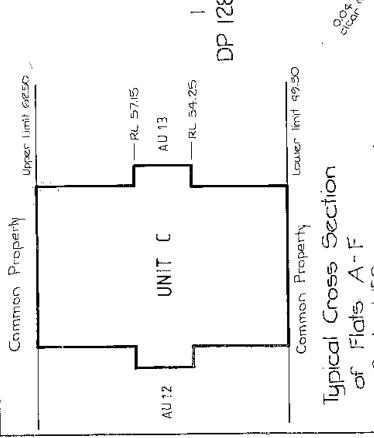

LAND DISTRICT NORTH AUCKLAND
 SURVEY BLK & DIST VIII RANGITOTO
 NZMS 261 SHT RECORD MAP No AK 44

UNITS ON LOT 1 DP 150025

Header from DPAGE

